

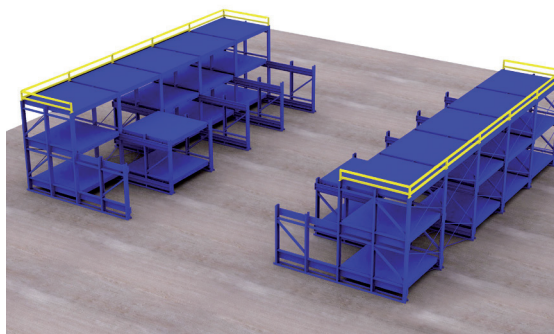

Rack

Slide Rack (Mold Rack)

Since this is a full slide-type, removal of mold and heavy is done smoothly. Also it can ensure work efficiency improvement and safe of worker. Because it can sterically storage, it can be effective use of the space.



Cantilever Rack

Because there is no partition of the columns at the front, it is the best type to store the pipe steel, scrolls, such as long object that can not be palletized.

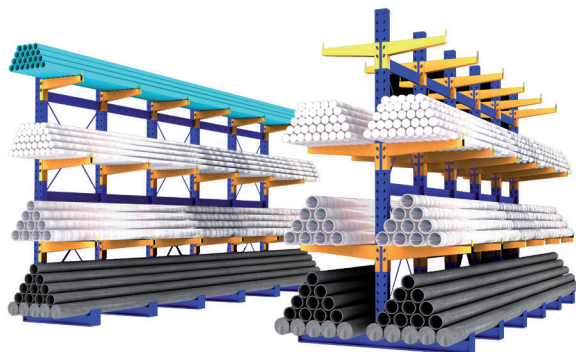

Mobile Rack

It is most efficient for space effective use of limited. It is also very effective for the purpose of keeping the airtightness. In addition, it is widely used also for the purpose of document storage and valuables.

